

Installation instructions for PZ4AL- 01896- 00

Toyota Camry, Lexus ES 350



Under Run Protective Shield engine bay and transmission case

Toyota Camry



Lexus ES 350



Model Year:	2006	2007
Vehicle Code:	GSV40L-RETGKW	GSV40L- BETGKC
Part Number:	PZ4AL-01896-00	PZ4AL-01896-00
 Weight:	6,48kg	6,48kg
 Installation Time:	20 min	20 min

A

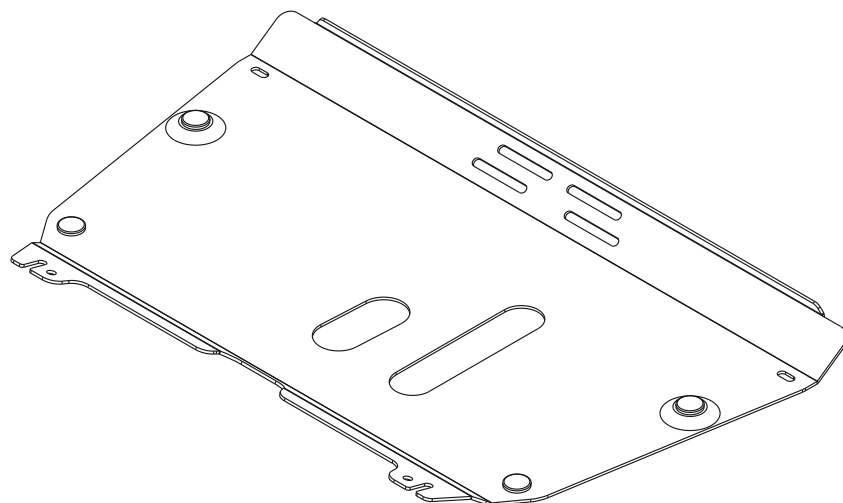

PZ4AL- 01896- 60

B1

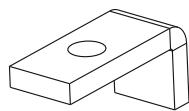

x 2

B2

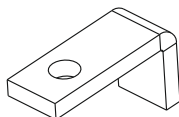

x 2

C

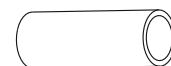

x 2

D

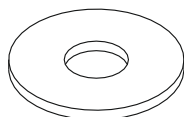

4 x Ø10

E1

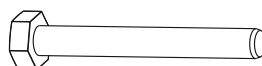

2 x M 10x80

E2



2 x M 10x140

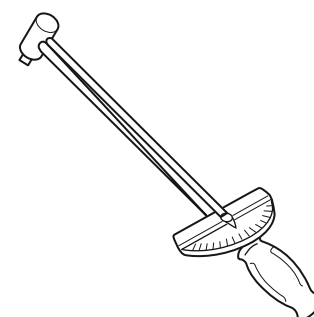
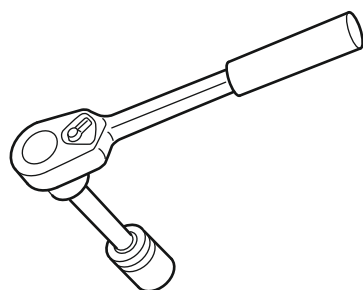

1

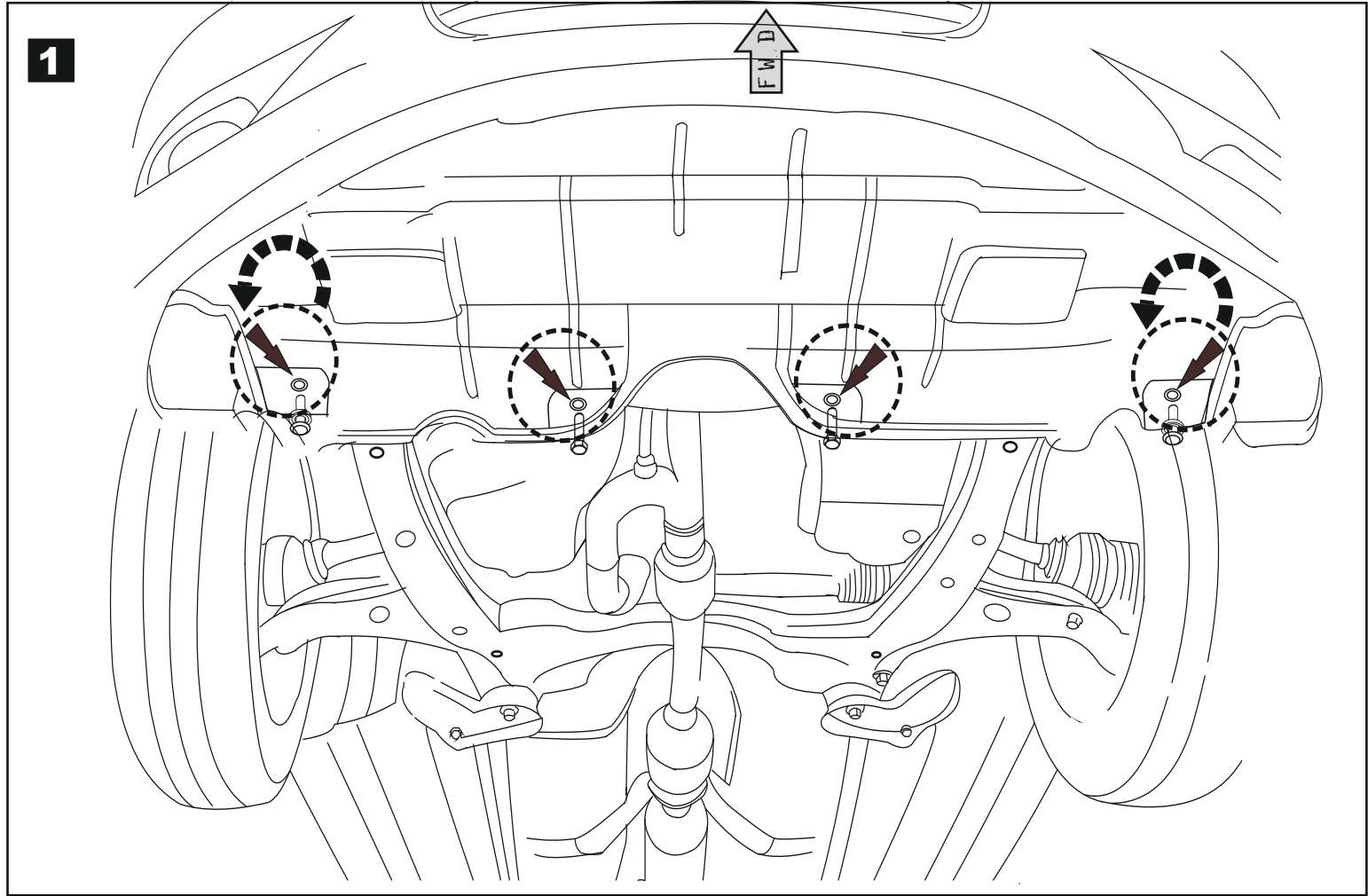

2

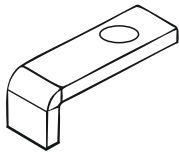

FWD

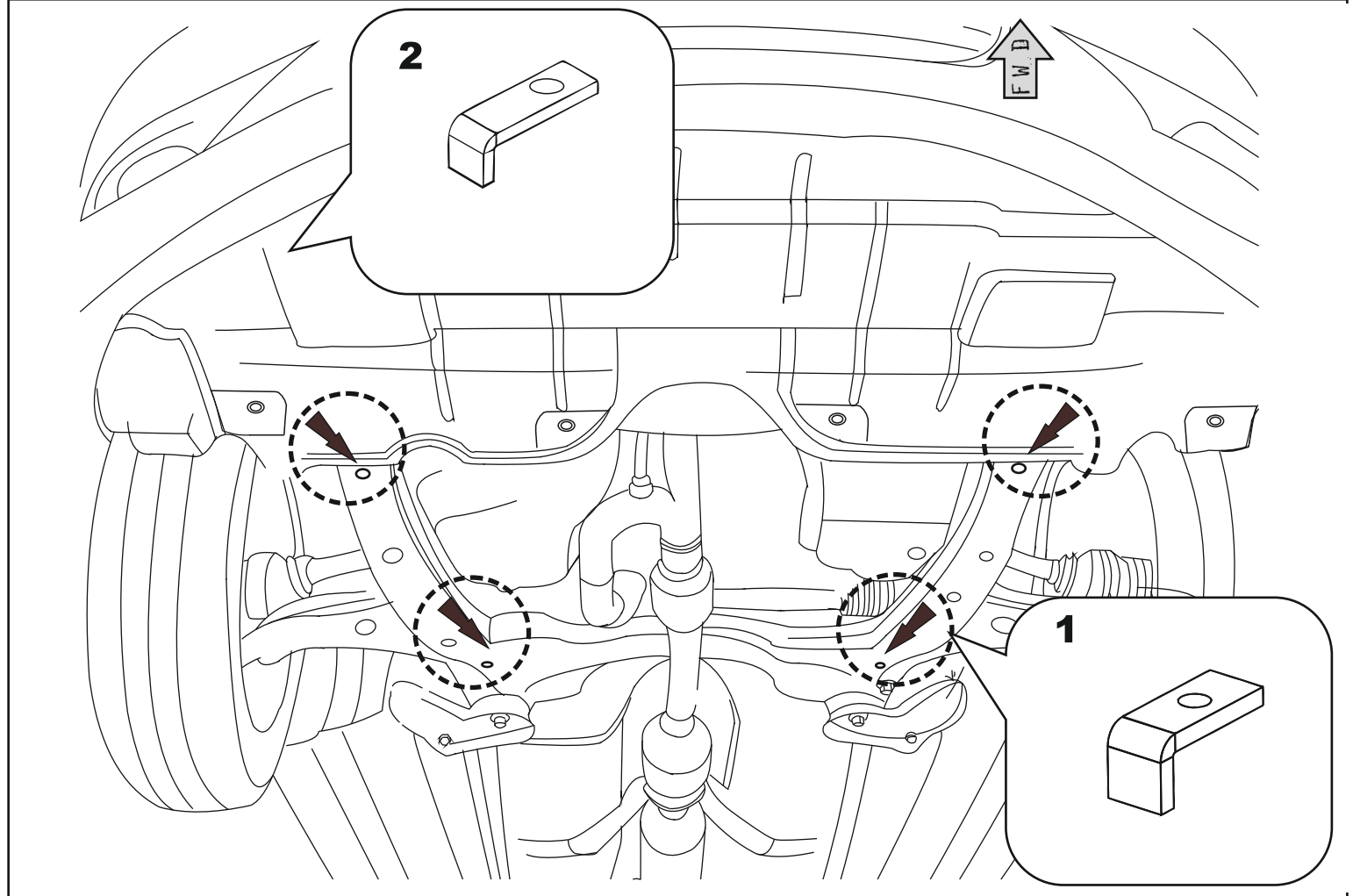

1

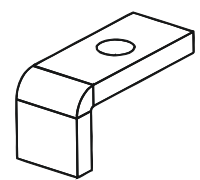

3

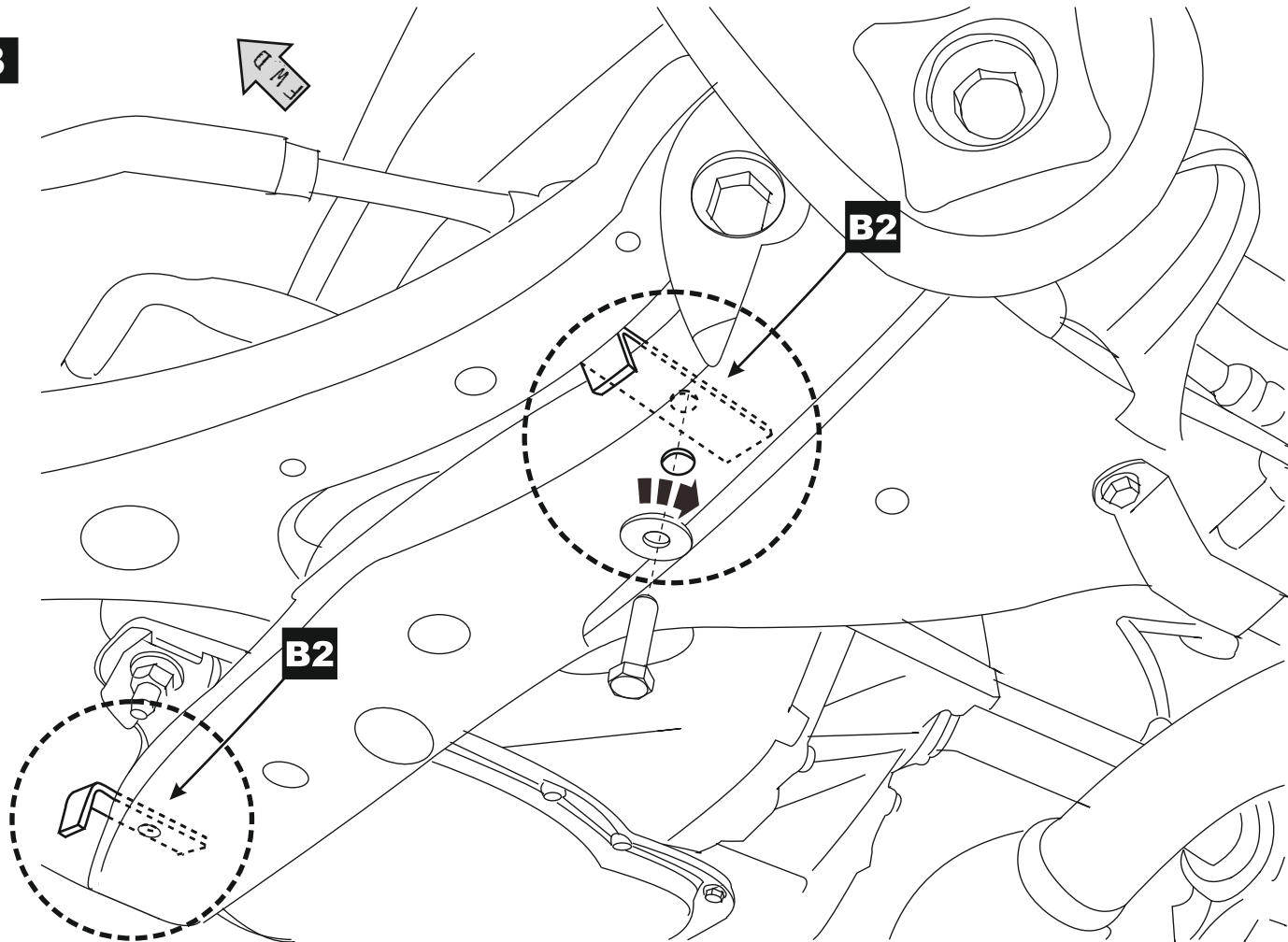

4

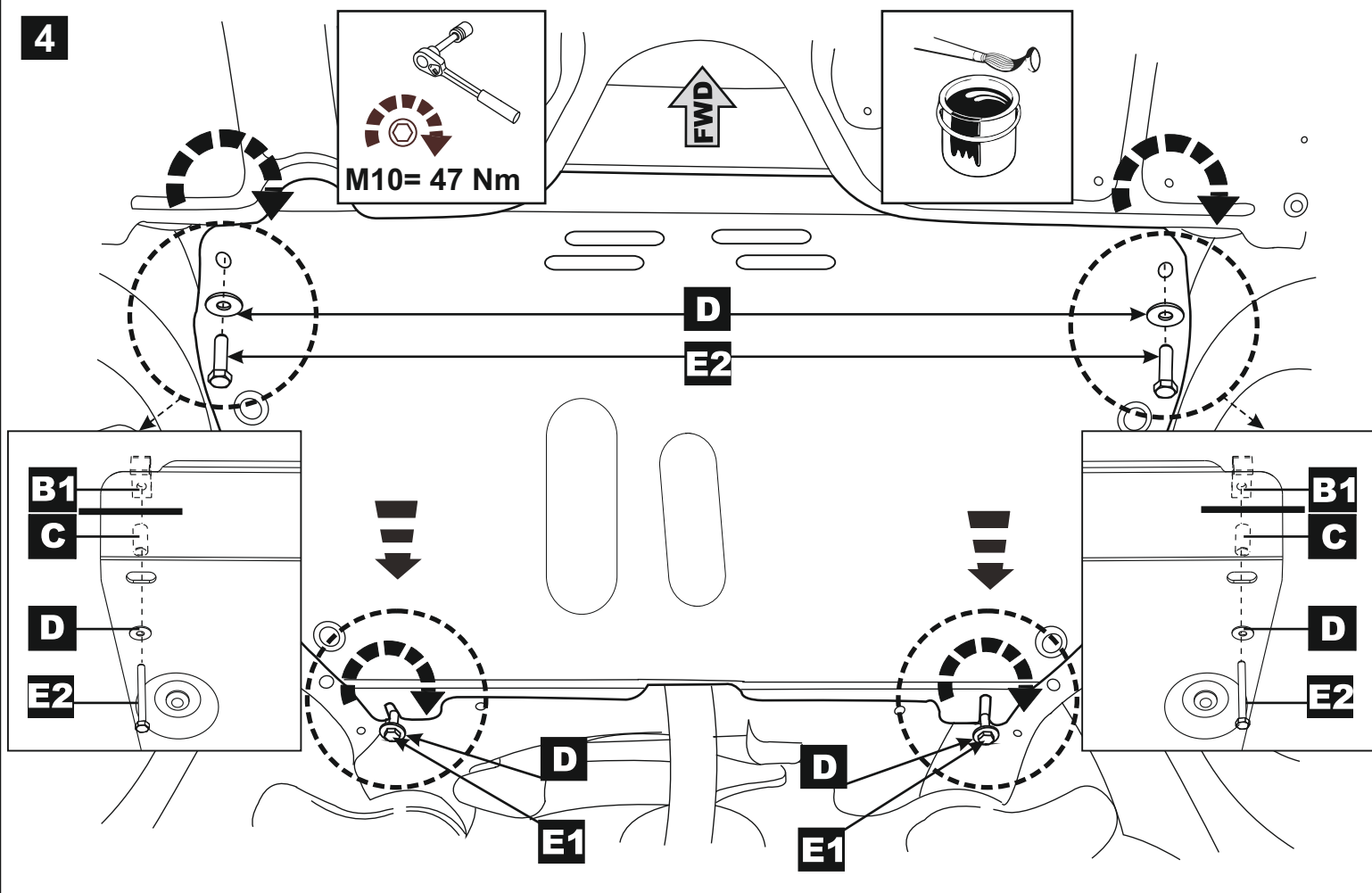

5

